

Planeo 4021



11 1/2 in x 1 1/4 in or 290 mm x 30 mm

Technical datasheet



Planeo 4021

WHS: Wood hybrid system

Geolam®

Architectural Eco-Technology



Section tolerances in mm: +/- 2.0 mm or +/- 3/32 in

The outer wpc layer is sanded. The provided dimensions are average thickness (as well for all drawing in that document)

Fire rating:

On request:

ASTM E-84 class A

Euroclass NF EN 135011 : B, s3-d0

Euroclass NF EN 135011 : A2, s3-d0

NFP 92 -507 : M2 or M1

Surfaces finish: Sanded

Other surface textures available on request. Sanding finish and/or shading may vary between runs. WPC thickness may vary in compliance with flame test requirements.

Profiles fastening and installation: Planeo boards cannot be cut within the bolts at either board end. Refer to our website www.geolam.com

Technical information may change without warning.

Standard length: 9 ft 10 in | 3.0 m

On order any length from: 7 ft to 27 ft | 2.15 m to 8.25 m

Weight: 2.78 lb/ft | 4.13 kg/m

Secondary moment Ix (cm⁴): 15.17

Secondary moment Iy (cm⁴): 807.89

Section modulus Z+x (cm³): 11.24

Section modulus Z-x (cm³): 11.24

Section modulus Z+y (cm³): 56.3

Section modulus Z-y (cm³): 56.3

Core in anodized aluminum alloy: A6063S-T5 Serie 6000

Coefficient of Thermal Expansion (20-100°C):

23.4 μm/m/°C

Modulus of Elasticity: 68.9 GPa

Max Tensile Strength: 186 Mpa

Carbon Footprint:

WPC : 1.54 kg CO₂ /Kg WPC

Alu : 0.87 kg CO₂ /Kg Alu



Teak



Limba



Rosewood



Wenge



Bilinga



Carbon



Ivory



Any color on request

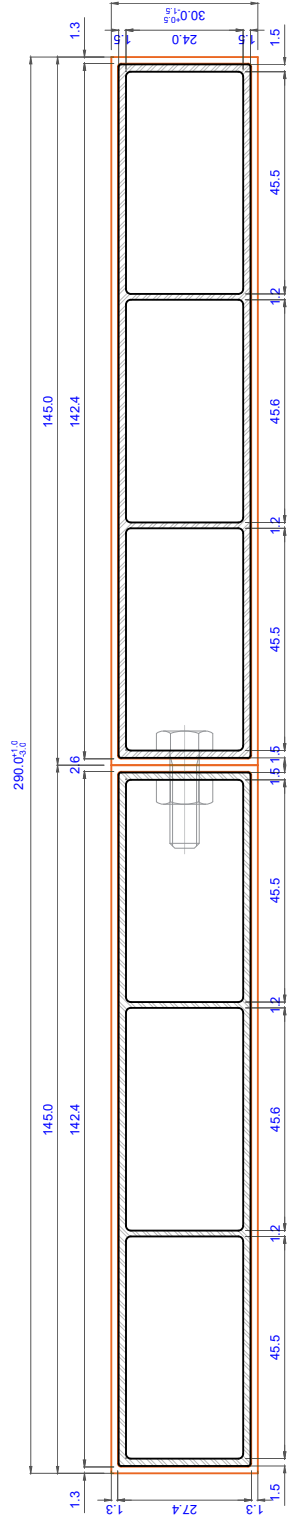

Technical specifications, dimensions in mm		Cross section coefficient Z+x (cm ³)	11.24	Wood hybrid system WHS	Type 1.0
Weight (lb/feet)	2.77	Cross section coefficient Z-x (cm ³)	11.24	Planeo 4021	
Cross section, secondary moment Ix (cm ⁴)	15.17	Cross section coefficient Z+y (cm ³)	56.30		
Cross section, secondary moment Iy (cm ⁴)	807.89	Cross section coefficient Z-y (cm ³)	56.30		